

BreathScan®

ALCOHOL DETECTOR

Learn More About
Breath Scan Employee Drug Testing Kits

 EmployeeDrugTestingAce.com

Trusted Proven Secure

www.DrugTestingAce.com

www.EDTAce.com

INSTRUCTIONS

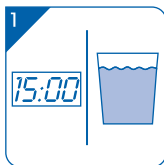

1. Wait 15 minutes after last alcoholic drink (alcohol takes about 15 minutes to have an effect on your system) OR drink a glass of water before taking the test.

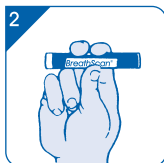

2. Squeeze middle of the outer plastic tube between thumb and forefinger to break inner glass ampule containing yellow crystals SQUEEZE ONLY ONCE. DO NOT CRUSH OR BEND TUBE. Use tester immediately

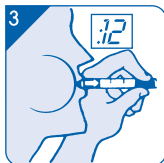

3. Take a deep breath and blow, in one continuous breath, for 12 seconds through the end of the tube designated by arrow. BLOW VERY HARD. EXHALE THROUGH THE TUBE, DO NOT INHALE. Shake tester to distribute crystals evenly, wait two minutes. Identify color change of majority of crystals.

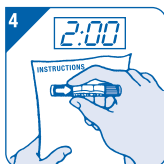

4. Testers will develop an aqua (blueish green/greenish blue) cast at levels at or above the level designated by the tester. For best results, compare to unused tester.

BREATHSCAN® Alcohol detector is available in several configurations. Check your *BreathScan*® tester for its configuration. It is indicated by a specific fraction of a percentage point such as .02%, .04% etc. on the left side of the tester. Check the legal limit for intoxication in your state.

Note: Accuracy of test results may not be reliable if test is not conducted according to instructions.

Refrain from driving after drinking. Do not drive at all if any crystals change color.

FOR ADDITIONAL INFORMATION AND WARNING SEE BACK OF THIS PAMPHLET.



BreathScan®

ALCOHOL DETECTOR

BreathScan® brand detector is a disposable breath alcohol indicator designed for one-time use. The BreathScan® detector contains indicator chemistry which will undergo a color change in the presence of alcohol contained in the breath of the subject. This product provides a reliable indication of alcohol present in the exhaled breath of the test subject when the instructions for use of the BreathScan® indicator are rigidly followed. The manufacturers, suppliers, agents, distributors and retailers make no warranty, expressed or implied, as to the ability of this device to determine or detect intoxication of the subject or to accurately indicate the subject's blood alcohol level. Decisions and/or actions based on the use of this product by any person shall be at such person's own risk. The manufacturers, suppliers, agents, distributors and retailers assume no responsibility for consequences of subjects who test negative using this device but who later show that they are under the influence of or their judgment has been impaired by alcohol.

WARNING: This product should be used only as a screening device and is only an indication of the possible presence of alcohol in the blood of the test subject. Correlation between breath alcohol content and blood alcohol content depends on many variables, including altitude. The exact concentration of alcohol in the blood of the test subject

cannot be accurately determined by using this device.

This device is not intended to legally determine blood alcohol presence or level. No inference of intoxication is to be made from a positive indication. *BreathScan®* is guaranteed to be free from manufacturer's defects. This warranty is expressly made in lieu of any and all other warranties expressed or implied including the warranties of merchantability and fitness for a particular purpose or use. There are no warranties expressed beyond the description of the product contained on this package. The warrantor expressly disclaims liability for incidental, special, or consequential damages of any nature.

Use immediately after breaking glass vessel. Do not use if glass vessel containing crystals is ruptured prematurely or if crystals are not yellow.

Store at room temperature.

Keep out of reach of children.
Do not immerse in liquid.

DO NOT INGEST.

If ingested, induce vomiting and contact your physician.

BreathScan® is a registered trademark of
WNCK, Inc.

Patented under U.S.
Patent #4, 740, 475
MADE IN U.S.A.

Brought to You by Employee Drug Testing Ace

Buying discounted, accurate, high quality employment drug testing kits and services is affordable, fast, easy, safe and secure with **Employee Drug Testing Ace**. You can buy employment, pre-employment and employee drug and alcohol testing kits, services and supplies tailored for employers, TPAs, nursing homes, hospitals, manufacturing, moving companies, Department of Transportation DOT, local and Federal Government agencies, auto dealerships, construction, DOD, the work place, employment agencies and more.

Our easy to use [employee drug testing](#) kits are DOT Approved, CLIA Waived, FDA 510k Cleared and SAMHSA Compliant. We provide both onsite employment drug screening and offsite employee drug screening services along with SAMHSA certified confirmation and medical review officer (MRO) services. All [employment drug screening](#) kits are on sale, discounted, and have [bulk / volume discounts](#).

- **Pay No Taxes in the USA.**, except California.
- **100% Free UPS Standard Shipping** in the Continental U.S.A. for *All* Products.
- **100% Free FedEx Overnight Shipping** in the Continental U.S.A. for *All* Specimens sent in as part of our SAMHSA Certified Confirmation Drug Testing Service.
- Onsite Third Party Administered (TPA) Employee Drug and Alcohol Collection Services.
- Over 12,000 Offsite Employee Drug and Alcohol Testing Locations Nationwide.
- The most complete [Employment Drug Testing Resource Center](#) including: information, official documents, work place drug testing information, forms, work accident info, charts, videos, post accident drug testing info, training materials, contact lists, definitions and more!

We sell affordable and guaranteed [employee drug screening](#) kits and services available at the best prices. Our prices may be cheap but our drug testing kits are of the highest quality and accuracy. If you are in the market for discounted high quality pre-employment, employee, or [employment drug testing](#) and screening kits and services, visit us today. You will be happy you did!