



# iScreen™

One Step Drug Card



## iScreen™ One Step Drug Card

*Corporate Drug Testing Made Simple.*

- Simple dip and read procedure
- Room temperature storage
- Laboratory accurate
- 1-10 drug configurations available
- Results in minutes
- 24-month shelf life

*Innovative Drug Screening Solutions*  
**Quality • Choices • Support**

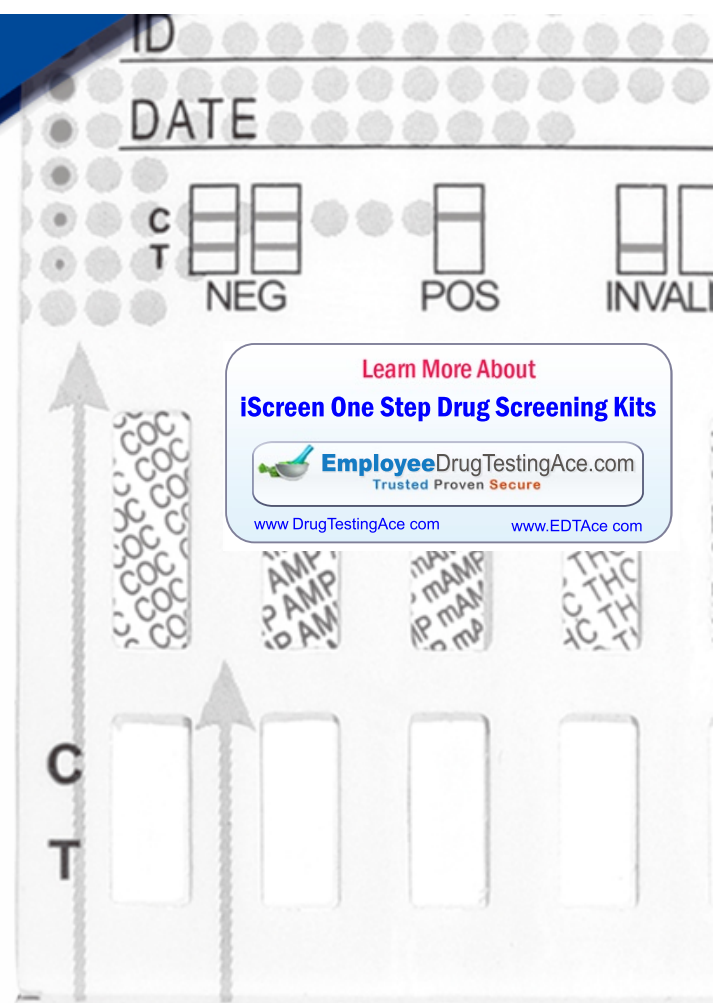

Learn More About  
**iScreen One Step Drug Screening Kits**

 **Employee Drug Testing Ace.com**  
 Trusted Proven Secure

[www.DrugTestingAce.com](http://www.DrugTestingAce.com)

[www.EDTAce.com](http://www.EDTAce.com)

Instant Technologies, Inc.



an  inverness medical company



# iScreen™

One Step Drug Card

## iScreen™ One Step Drug Card

Corporate Drug Testing Made Simple.

Detect the presence of drugs in minutes.  
It's drug testing efficiency you can count on.

Drug Name:	Abbreviation:	Cutoff Levels:
Amphetamine.....	AMP.....	1000ng/ml
Barbiturates.....	BAR.....	300ng/ml
Benzodiazepines.....	BZO.....	300ng/ml
Cocaine.....	COC.....	300ng/ml
Ecstasy.....	MDMA.....	500ng/ml
Marijuana.....	THC.....	50ng/ml
Methadone.....	MTD.....	300ng/ml
Methamphetamine.....	mAMP.....	1000ng/ml
Morphine.....	MOR.....	300ng/ml
Opiates.....	OPI.....	2000ng/ml
Oxycodone.....	OXY.....	100ng/ml
Phencyclidine.....	PCP.....	25ng/ml
Propoxyphene.....	PPX.....	300ng/ml
Tricyclic Antidepressants.....	TCA.....	1000ng/ml



iScreen Dip Card single and 5 panel shown above.

### Instructions

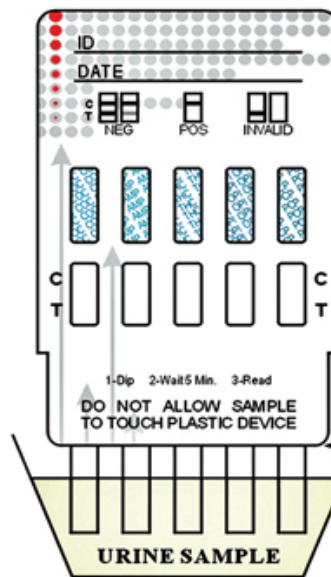
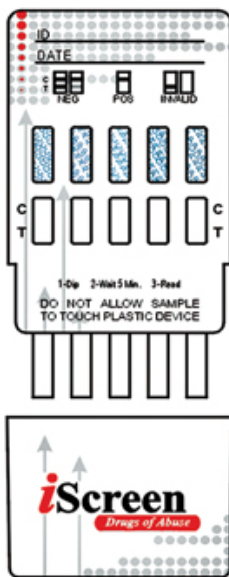

This illustration shows a 5-Drug Test Card

Do not allow specimen to touch the device housing

1. Remove iScreen™ test from foil pouch at room temperature. Take off the cap revealing the testing strips.
2. Immerse test vertically in the urine sample for at least 10 - 15 seconds. Do not allow the specimen to touch the device housing.
3. Read at five (5) minutes. Results stable up to four (4) hours.



#### Interpretation of Results:

 <b>Negative</b> (2 Lines - Any indication of a line in both test and control fields is to be interpreted as a NEGATIVE)	 <b>Non-Negative</b> (1 Line)	 <b>Invalid</b> (No line(s) or no control line(s))
--	-------------------------------------	--